

14, Park View Lymm, WA13 0UA

Offers Over £175,000

🛏 2 🚿 1 🚿 1



Having been well maintained over the years this park home offers ready to move into accommodation and briefly comprises:- comprises:- Entrance hallway, lounge/dining room, kitchen, 2 double bedrooms, shower room and conservatory. Externally there is a lawned garden with delightful views over open countryside and beyond. This development is strictly for the over 50's.

Key Features

- Two bedroom park Home
- Delightful countryside views
- Lounge/dining room
- Conservatory
- Fitted Kitchen
- Shower Room
- Off-road parking
- Well maintained throughout
- Viewings highly recommended
-

694 sq.ft. (64.5 sq.m.) approx.

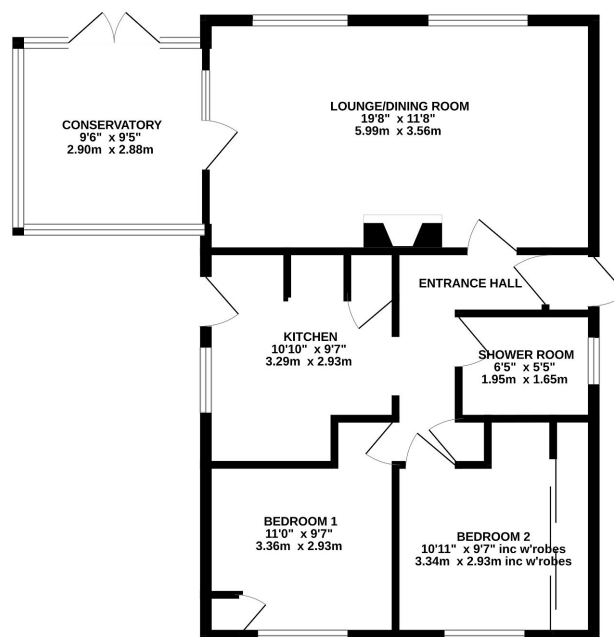

TOTAL FLOOR AREA : 694 sq.ft. (64.5 sq.m.) approx.
Whilst every attempt has been made to ensure the accuracy of the floorplan contained herein, measurements of doors, windows, rooms and any other items are approximate and no responsibility is taken for any error, omission or mis-statement. This plan is for illustrative purposes only and should be used as such by any prospective purchaser. The services, systems and appliances shown have not been tested and no guarantee as to their operability or efficiency can be given.
Made with Metrepro 12/2014